

GENERAL NOTES

- THE DESIGN ON THIS DRAWING IS COPYRIGHT AND REMAINS THE PROPERTY OF THE ENGINEER.
- ALL WORK IS TO BE CARRIED OUT STRICTLY IN ACCORDANCE WITH LOCAL AND MUNICIPAL REGULATIONS.
- ALL DIMENSIONS AND LEVELS ARE TO BE CHECKED ON SITE BEFORE WORK IS PUT IN HAND.
- ANY DISCREPANCIES ARE TO BE IMMEDIATELY REPORTED TO THE ENGINEER.
- THE DRAWING MAY NOT BE SCALED.
- DRAWING WAS CREATED USING AUTOCAD SOFTWARE

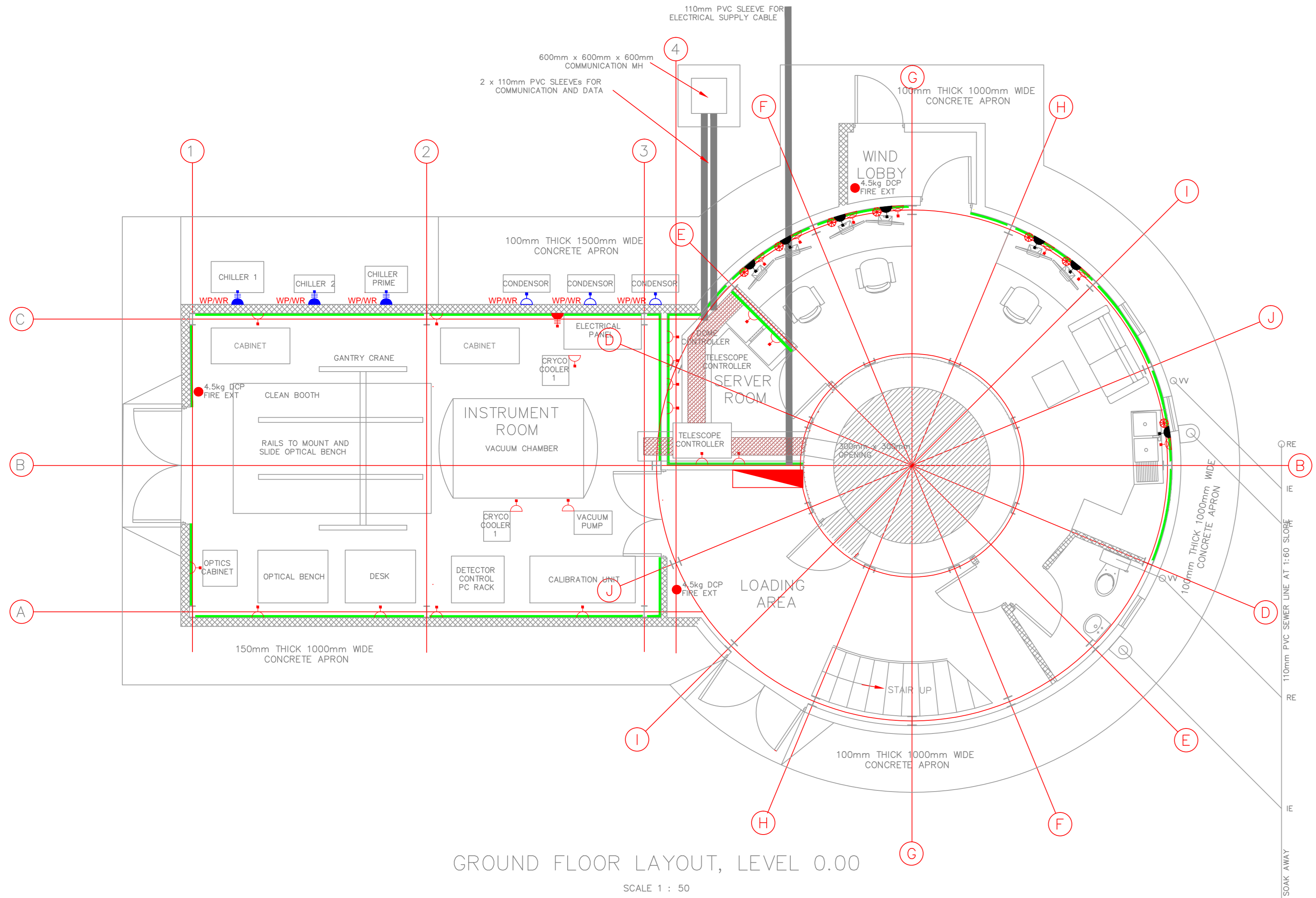

GROUND FLOOR LAYOUT, LEVEL 0.00

SCALE 1 : 50

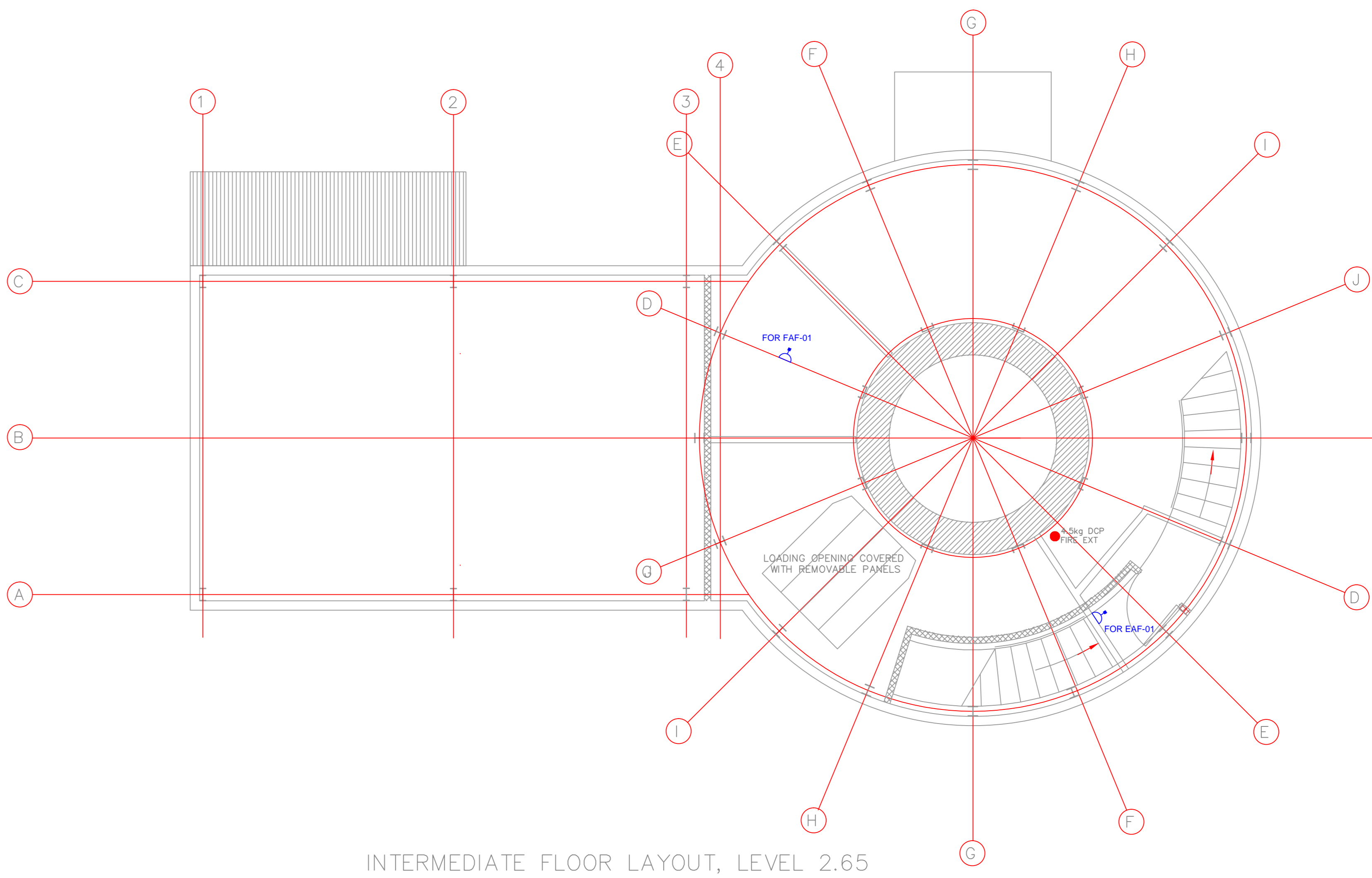

INTERMEDIATE FLOOR LAYOUT, LEVEL 2.65

SCALE 1 : 50

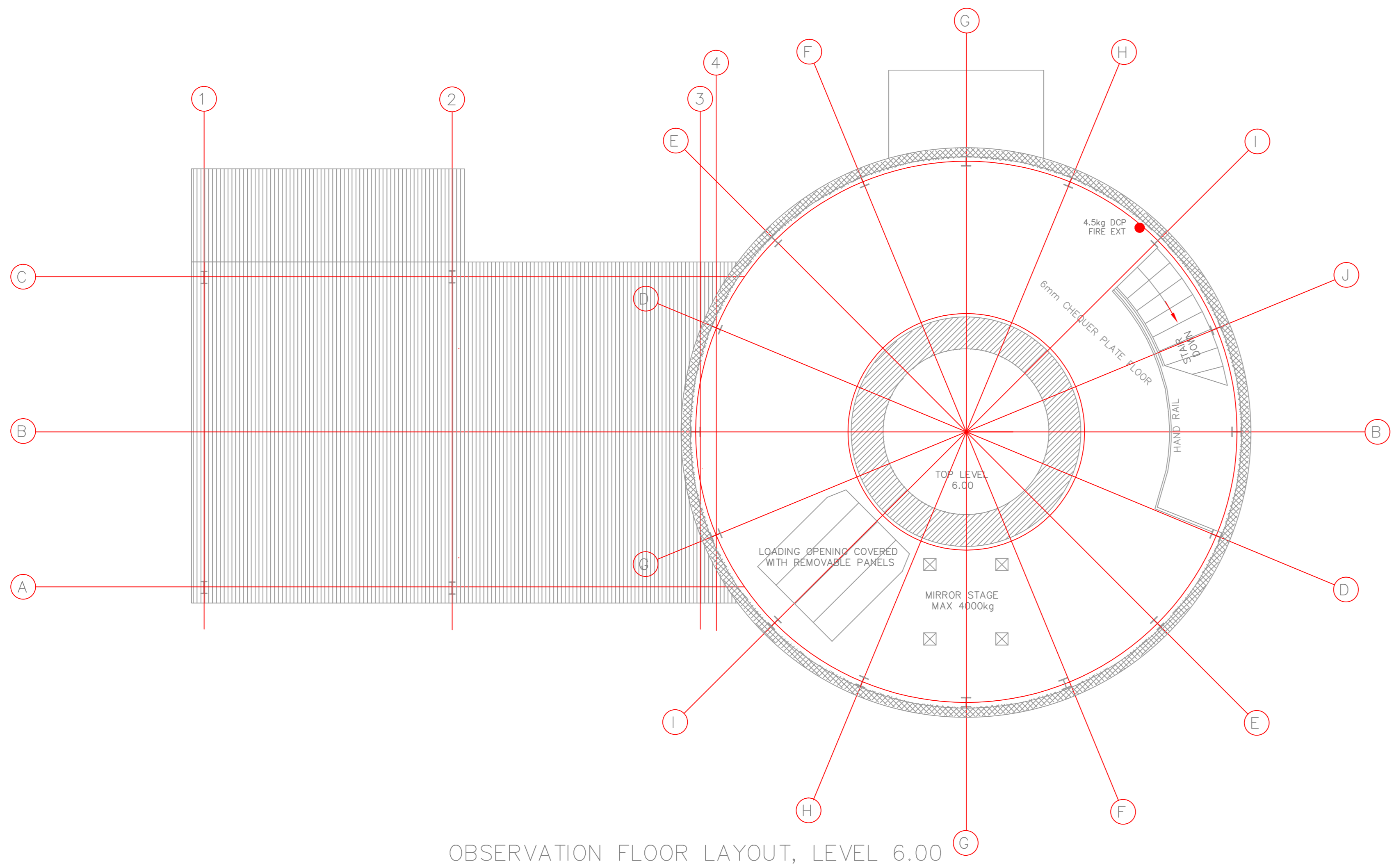

OBSERVATION FLOOR LAYOUT, LEVEL 6.00

SCALE 1 : 50

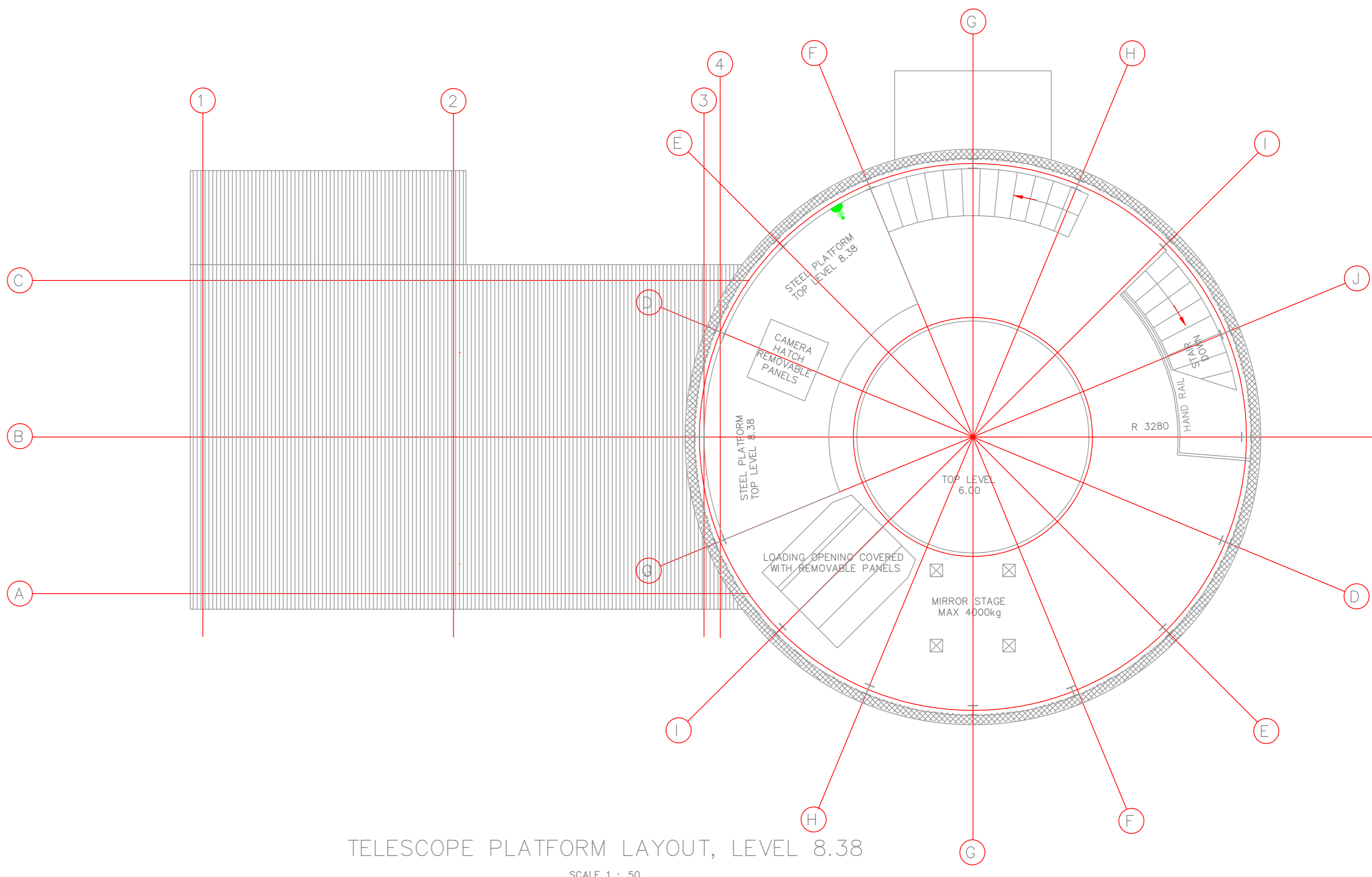

TELESCOPE PLATFORM LAYOUT, LEVEL 8.38

SCALE 1 : 50

LEGEND	
	ELECTRICAL DB.
	16A SWITCHED SOCKET OUTLET COMBO, 1X 3pin RSA and 1X 3pin Euro
	16A DEDICATED SWITCHED SINGLE SOCKET OUTLET NOT ON EARTH LEAKAGE
	10A-15A JAPAN SO
	20A SINGLE PHASE ISOLATOR P/P (100V)
	20A SINGLE PHASE ISOLATOR P/P (220V)
	100A THREE PHASE ISOLATOR P/P (200V)
	20A THREE PHASE ISOLATOR P/P (200V)
	75A THREE PHASE ISOLATOR P/P (200V)
	3 COMPARTMENT PVC POWER SKIRTING.
	WP/WR WATER PROOF / RESISTENT EQUIPMENT.

SPECIFICATIONS

1. ALL CONDUITS TO BE PVC.
2. ALL FLUSH SSO BOXES TO BE PVC.
3. ALL FLUSH SSO's TO BE CLIPSAL S2000.
4. ALL POWER SKIRTING TO BE 3 COMPARTMENT. CABSTRUT- COLOUR GREY.
5. ALL POWER SKIRTING SSO's TO BE CLIPSAL S2000.
6. ALL FLUSH ISOLATORS TO BE CLIPSAL S2000.
7. ALL EXTERNAL W/P ISOLATORS TO BE GEWISS.
8. ALL INTERNAL SURFACE MOUNTED ISOLATORS TO BE CLIPSAL S2000.

ISSUED FOR
TENDER

REV No.	DATE	DESCRIPTION	DRAWN
T1	2008/2019	ISSUED FOR TENDER	SJ

CHARL
ELECTRICAL ENGINEERING CC
ENGINEERS & CONSTRUCTORS

26 Taurus St, Brackenfell Industria,
Brackenfell, 7560
P.O. Box 298, Brackenfell, 7561
T: (021) 981-9120/1
F: (021) 981-9122
E: ce@charle.co.za
Reg Nr: 1992/033460/23
www.charleengineering.co.za

PROJECT
PRIME BUILDING

CLIENT
SUTHERLAND OBSERVATORY

DRAWING
POWER LAYOUT

PROJECT NUMBER	DRAWING NUMBER	REVISION	PLOT DATE
CEE633	GL-P1	T1	20/08/2019
SCALE	COUNCIL	INFORMATION ONLY	CONSTRUCTION
A0=1:50	22/07/2019	SJ	CVVT